

HOUSE rules



HOBBY LOBBY®

TIPS & TRICKS
for creating your
DREAM DOLLHOUSE

Home Sweet Home

The Victoria's Farmhouse has two wrap-around porches, leaving plenty of room for adorable miniatures. We added tiny packages, sweet little porch benches, and even mini caladium planters (sold ready to go) on the upstairs windows.

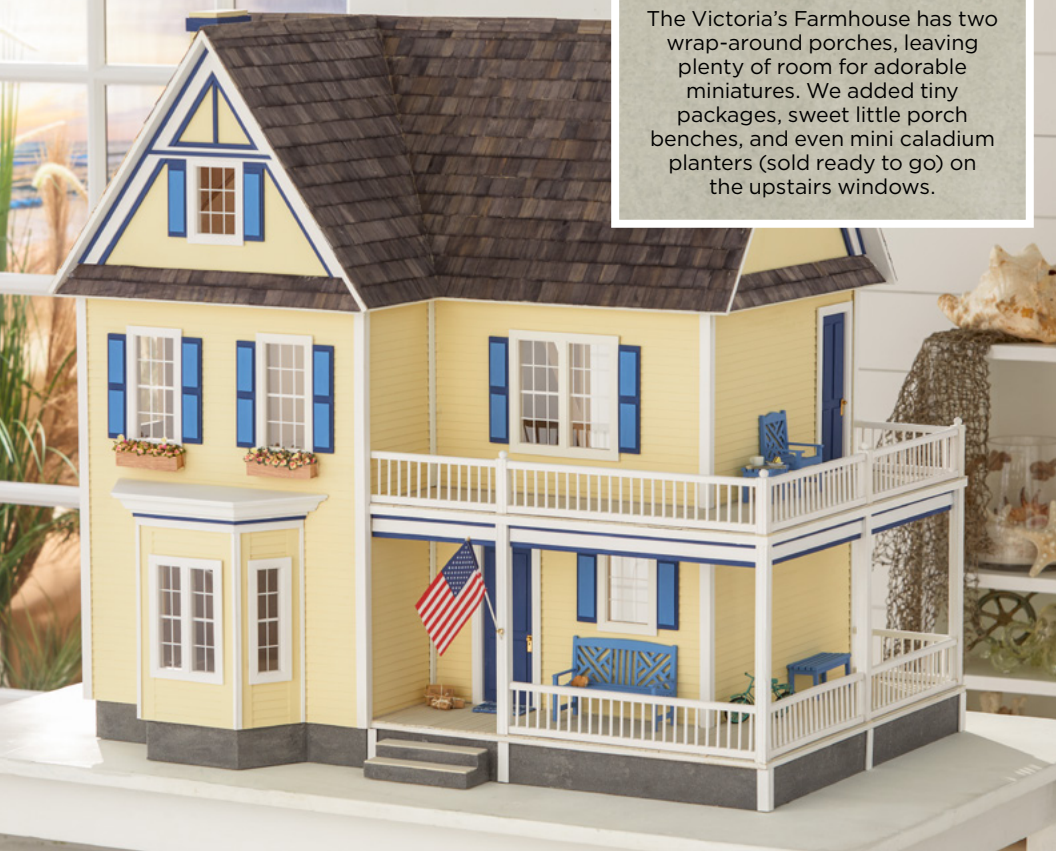

Window Work

A little trick for a clean paint job around exterior details like windows, shutters and railings: Use a heat gun to melt the adhesive and a palette knife to safely remove them from the house. Then paint the details (and the exterior walls they hang on) separately.

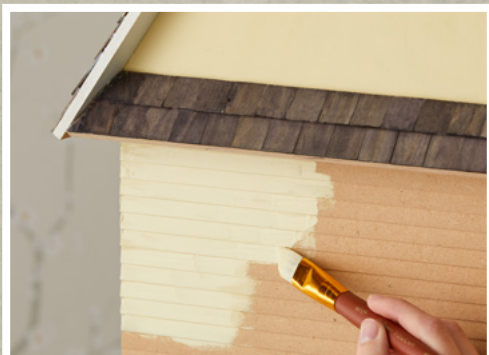

On the House

Use a healthy coat of chalk paint to cover the exterior of the house—chalk paint doesn't require a primer, and the matte finish mimics the look of a real house.

Tip: Sand down any coarse spots on the wood and cover details with tape before painting.



Shingle Mingle

For dollhouses that have pre-attached shingles, apply stain with a paintbrush, working in rows from the peak of the roof down. And here's an idea: You can use two different shades of stain to create patterns on the roof.

Supplies



1



2



Batch Dyeing

SUPPLIES:

- Shingles
- Powdered shingle dye
- Mixing bowl
- Gloves
- Hot glue gun/sticks

1. Following manufacturer's instructions, mix shingle dye with water. Submerge shingles in solution.
2. Hot glue shingles onto dollhouse roof.

Cottage Core

Created from the Bungalow dollhouse, this fairytale cottage comes to life with real Spanish moss and cobblestones made from high-density EVA Foam.

On the Cover: The Vermont Farmhouse Jr. Dollhouse is painted with black and white chalk paint, and the window panes and porch beams are stained to look like cedarwood.



Supplies



1



2



3



Cobblestone Accent Wall

SUPPLIES:

- Iron
- Wood burning tool
- Scissors
- Mixing Cups
- High-density EVA foam
- Tin foil
- Chalk paint
- Craft acrylic paint
- Paintbrushes

1. Carve cobblestone shapes into EVA foam with wood burning tool.

2. Heat iron to hottest setting. Crinkle tin foil, then add texture by gently pressing foil into EVA foam with iron. Repeat as needed.

Warning: Foil will be hot. Allow to cool before touching.

3. Paint outlines with darker colors and cobblestones with lighter colors.

1



2



3



4



No Pane, No Gain

Note: Use a craft knife to remove existing grilles from windows.

1. Stained Glass: Trace design onto window with liquid leading paint and let dry. Fill in the spaces with stained glass effect paint.

2. Leaded Glass: Cut glass to fit window frames. Cut and secure copper tape onto glass in diamond pattern. Solder copper tape together, painting glass in between.

3. Farmhouse: Remove upper third of grille. Cut balsa wood to fit window and adhere above grilles to create transom.

4. Contemporary: Tape off all the edges, then paint the window frame and grilles black.

Pretty in Pink

The Victorian-style Alison Jr. Dollhouse has six whole rooms and an attic, which means you'll have lots of spaces to customize.

Tip: To give the window shutters a two-toned look, remove the rectangular panels, paint each piece separately, and glue them all back together.





▲ Hardwood Heaven

To finish your dollhouse's existing hardwood floors, carefully sand down the floors, apply a stain with a brush, and seal with a high-gloss varnish. Want the look without the work?

Try our premade hardwood flooring, sold ready to be cut and installed.

► Pleasant Painting

Like the clean look of white wood flooring? A coat of glossy craft paint will give you high shine (pictured here), while a white wood stain will allow the grain to peek through.

Tip: Paint the wooden flooring before customizing the walls—you can hide any stray brush strokes or paint drips later with wallpaper.





Tiles For Miles

Realistic tile, like the kind pictured here, is a quick and easy way to breathe life into laundry rooms, bathrooms, kitchens and more. Just be sure to keep the pattern intact as you cut and place your flooring.

Supplies

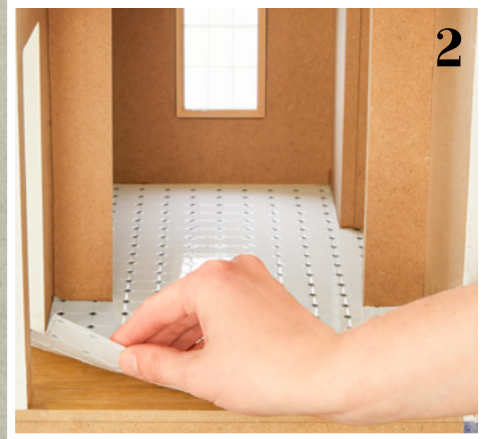

Applying Flooring

SUPPLIES:

- Dollhouse flooring
- Cutting mat
- Pencil
- Craft knife
- Paintbrush
- Ruler
- Dollhouse flooring paste
- Scrap paper

1. Use scrap paper to create a template of the floor. Cut out flooring according to template.

2. Apply flooring paste to back of flooring. Adhere paper to floor, starting from the back of the room and smoothing forward.

Supplies



Applying Wallpaper

SUPPLIES:

- Ruler
- Paintbrush
- Craft knife
- Scraper/spatula (for smoothing)
- Dollhouse wallpaper paste
- Cutting mat
- Dollhouse wallpaper
- Scrap paper

1. Use scrap paper to create a template of the wall. Cut out wallpaper according to template.

2. Apply wallpaper paste to back of wallpaper. Adhere paper to wall, using edge of scraper or spatula to smooth and remove air bubbles.



Open House

Here's the inside scoop on the Vermont Farmhouse Jr. Dollhouse, from floor-to-roof—faux tile, painted wood floors, wallpaper, wainscoting and, of course, all the adorable miniature furniture!